



HOWTH ROAD

NOTES

- THIS DRAWING IS TO BE READ IN CONJUNCTION WITH ALL ENGINEERS & ARCHITECTS DRAWINGS FIGURED DIMENSIONS ONLY (NOT SCALING) TO BE USED. WHERE A CONFLICT OF INFORMATION EXISTS OR IF IN ANY DOUBT - 'ASK'.
- CONSULTANTS TO BE INFORMED IMMEDIATELY OF ANY DISCREPANCIES BEFORE WORK PROCEEDS.

SITE BOUNDARY

SITE BOUNDARY

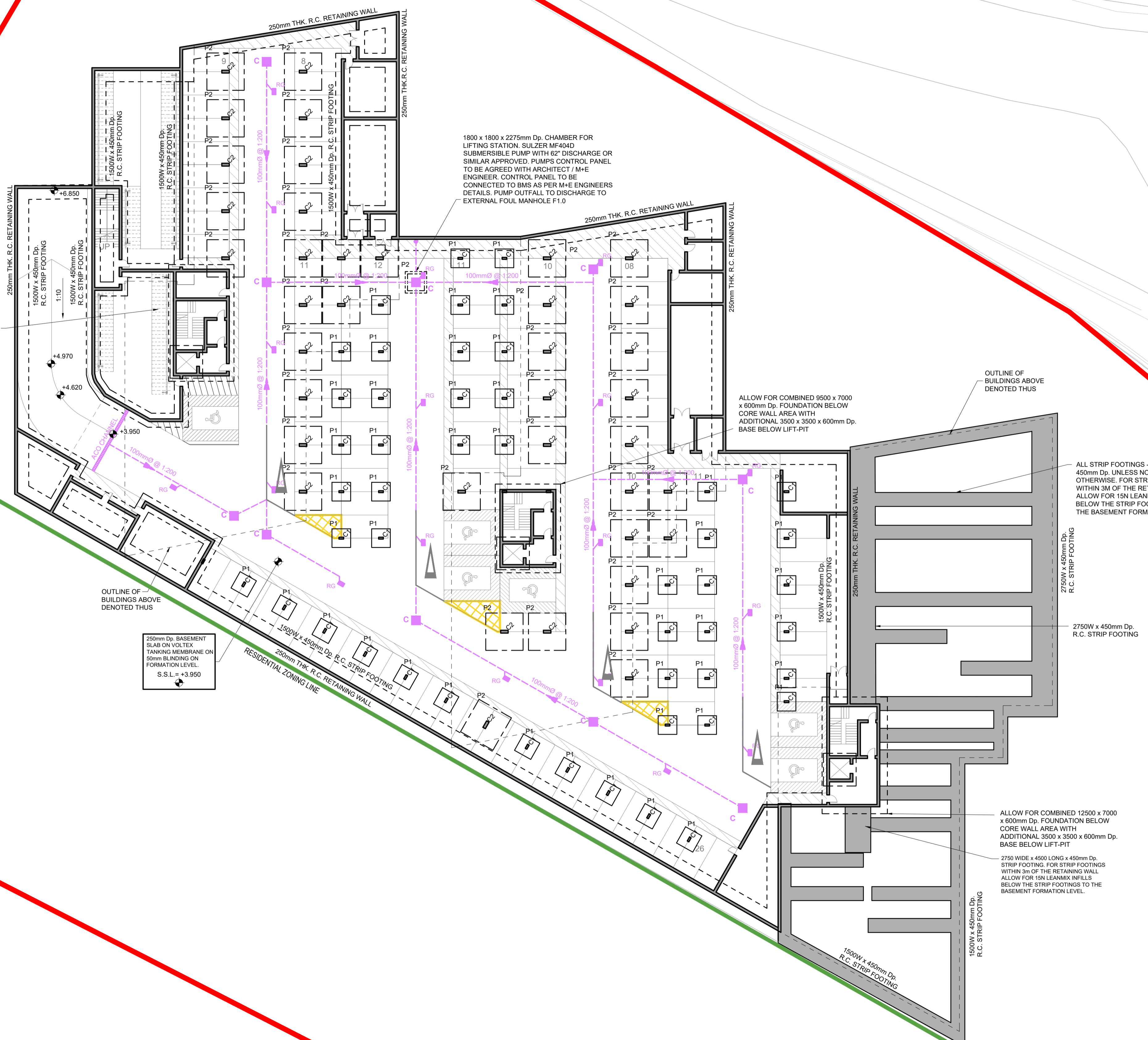

ALLOW FOR COMBINED 12500 x 7000 x 600mm Dp. FOUNDATION BELOW CORE WALL AREA WITH ADDITIONAL 3500 x 3500 x 600mm Dp. BASE BELOW LIFT-PIT

1800 x 1800 x 2275mm Dp. CHAMBER FOR LIFTING STATION. SULZER MF404D SUBMERSIBLE PUMP WITH 62" DISCHARGE OR SIMILAR APPROVED. PUMPS CONTROL PANEL TO BE AGREED WITH ARCHITECT / M/E ENGINEER. CONTROL PANEL TO BE CONNECTED TO BMS AS PER M/E ENGINEERS DETAILS. PUMP OUTFALL TO DISCHARGE TO EXTERNAL FOUL MANHOLE F1/D

ALLOW FOR COMBINED 9500 x 7000 x 600mm Dp. FOUNDATION BELOW CORE WALL AREA WITH ADDITIONAL 3500 x 3500 x 600mm Dp. BASE BELOW LIFT-PIT

ALL STRIP FOOTINGS - 1500 WIDE X 450mm Dp. UNLESS NOTED OTHERWISE. FOR STRIP FOOTINGS WITHIN 3M OF THE RETAINING WALL ALLOW FOR 15% LEANMIX INFILLS BELOW THE STRIP FOOTINGS TO THE BASEMENT FORMATION LEVEL.

ALLOW FOR COMBINED 12500 x 7000 x 600mm Dp. FOUNDATION BELOW CORE WALL AREA WITH ADDITIONAL 3500 x 3500 x 600mm Dp. BASE BELOW LIFT-PIT

250mm Dp. BASEMENT SLAB ON VOL. TEX. TANKING MEMBRANE ON 50mm BLINDING ON FORMATION LEVEL. S.S.L. = +3.950

PROPOSED BASEMENT LAYOUT

SCALE @ A1: 1:250
SCALE @ A3: 1:500

ISSUE	DATE	DESCRIPTION	AT	DRN	ORIG	P.D.
P5	20.05.21	ISSUED FOR SHD APPLICATION	AT	DRN	ORIG	SO
P4	21.06.20	ISSUED FOR PRE-APPLICATION	AT	DRN	ORIG	SO
P3	14.01.20	PRE-PLANNING ISSUE	AT	DRN	ORIG	SO
P2	18.12.19	ISSUED FOR COMMENT	AT	DRN	ORIG	SO
P1	10.12.19	ISSUED FOR COMMENT	AT	DRN	ORIG	SO

DRAWING STAGE **PLANNING**

BM Dublin Office: Sandwith House, 52-54 Lower Sandwith Street, Dublin 2, Ireland. Tel: (01) 677 3200 Fax: (01) 677 3164
London Office: 12 Mill Street, London SE1 2AY, United Kingdom Tel: (0044) 20 3750 3530
Consulting Engineers, Civil, Structural, Project Management. E-mail: bmce@bmce.ie Web: www.bmce.ie

BARRETT MAHONY
The Institution of Structural Engineers ACEI IBC International Federation of Consulting Engineers

CLIENT **GLL PRS HOLDCO LIMITED**

PROJECT TITLE DEVELOPMENT AT HOWTH ROAD	BM PROJECT No. 19196
MODEL REFERENCE	MODEL REV. SUITABILITY

DRAWING TITLE
PROPOSED BASEMENT LAYOUT

DRAWING No. HOW-BMD-00-ZZ-DR-C1002	ISSUE P5
--	--------------------